

FOR SALE

3.28 ACRE LIGHT INDUSTRIAL DEVELOPMENT SITE

820 Seaborne Avenue
Port Coquitlam, BC

LOT 2 - 3.28 ACRES



FRONTLINE
REAL ESTATE SERVICES

LOCAL FOCUS. POWERFUL RESULTS.

PROPERTY HIGHLIGHTS:

- 3.28 acres of industrial development land
- Convenient access to Lougheed Highway & Mary Hill Bypass
- One of the last remaining light industrial lots in the area
- Asking price: \$7,216,000

For more information
PLEASE CONTACT:

Todd Bohn
Personal Real Estate Corporation
d 604.676.4138
c 778.808.8633
todd@FLRE.ca

Owen Yates
Personal Real Estate Corporation
d 604.687.8320
c 604.315.5141
owen@FLRE.ca

www.FLRE.ca

FOR SALE

3.28 ACRE LIGHT INDUSTRIAL DEVELOPMENT SITE

820 Seaborne Avenue
Port Coquitlam, BC

OPPORTUNITY

The opportunity to purchase 3.28 acres of industrial development land in Port Coquitlam's Dominion Triangle. This is one of the last remaining light industrial lots in the area, which is experiencing rapid development. The property has potential for retail/showroom exposure on Nicola Avenue, facing Walmart in the Freemont Village Shopping Centre. Visit FLRE.ca/Seaborne to view this property's listing video.

PROPERTY FEATURES

- Site allows for an approximately 50,000 sf facility
- Frontage on Seaborne Avenue and Nicola Avenue
- Frontage facing retail in Freemont Village Centre
- Multiple access points to property

ZONING

The property is zoned Light Industrial (M3) which serves as a transitional zoning between industrial uses and nearby commercial and residential areas.

ASKING PRICE

\$7,216,000 (\$2,200,000/acre)

POTENTIAL SITE PLAN

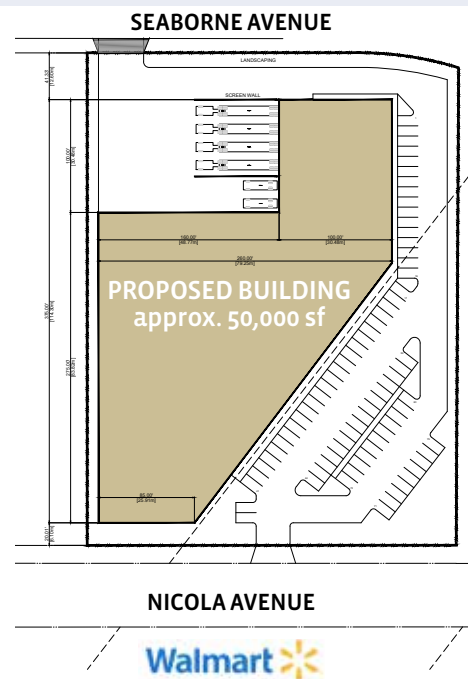

RENDERING FOR POTENTIAL BUILDING



FOR MORE INFORMATION CALL 604.583.2500

FOR SALE

3.28 ACRE LIGHT INDUSTRIAL DEVELOPMENT SITE

820 Seaborne Avenue
Port Coquitlam, BC

LOCATION

The subject property is located in Port Coquitlam's Dominion Triangle, just off Lougheed Highway and the Mary Hill Bypass. The area is experiencing rapid growth with many light industrial businesses building custom facilities in the immediate area. Ongoing development of River's Edge Industrial Park and Freemont Village Shopping Centre is drawing a variety of businesses, and thus amenities, to the neighbourhood. This is encouraged by residential development including Mosaic's Freemont Indigo Townhomes and a 500+ unit tower planned in Freemont Village.

PROPERTY DOCUMENTATION

The following information is available upon request:

- Survey - 2014
- Potential site plan
- Rendering for potential building
- Zoning - Light Industrial Zone (M3)

For access to the above documents please contact the listing agents.

LOCATION MAP

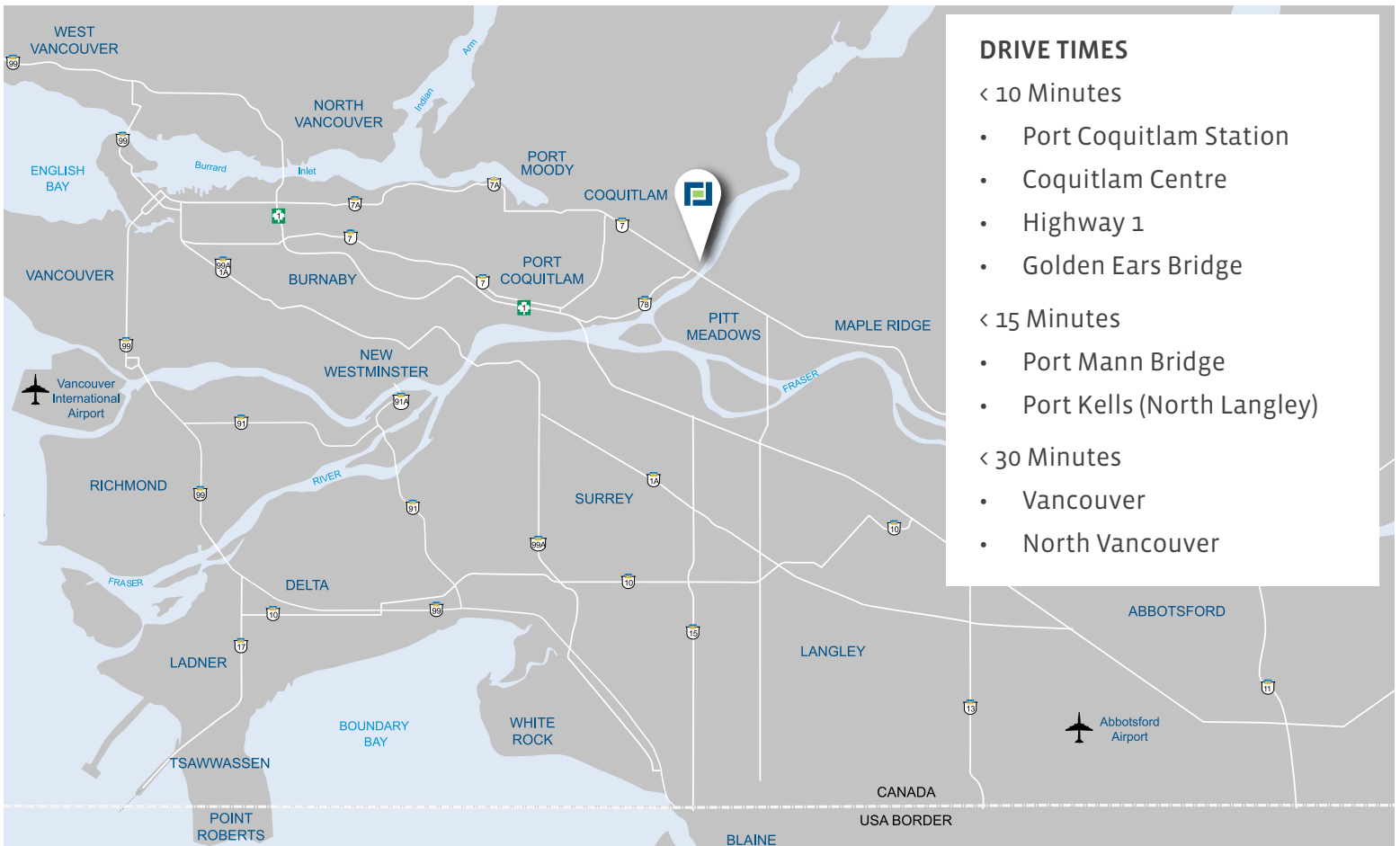

Todd Bohn

Personal Real Estate Corporation

d 604.676.4138

c 778.808.8633

todd@FLRE.ca

Owen Yates

Personal Real Estate Corporation

d 604.687.8320

c 604.315.5141

owen@FLRE.ca

160 – 8621 201 Street
Langley, BC V2Y 0G9

o 604.687.8300

f 604.687.8322

FLRE.ca



 **FRONTLINE**
REAL ESTATE SERVICES

E.&O.E: This document/email has been prepared by Frontline Real Estate Services Ltd. for advertising and general information only. The information contained herein was obtained from sources which we deem reliable and, while thought to be correct, is not guaranteed by Frontline Real Estate Services Ltd. Any interested party should undertake their own inquiries as to the accuracy of the information. Frontline Real Estate Services Ltd. excludes unequivocally all inferred or implied terms, conditions and warranties arising out of this document and excludes all liability for loss and damages arising there from.

LOCAL FOCUS. POWERFUL RESULTS.