

FOR SALE

FULLY LEASED SERVICE COMMERCIAL BUILDING

31897 & 31899
Mercantile Way
Abbotsford, BC



FRONTLINE
REAL ESTATE SERVICES

LOCAL FOCUS. POWERFUL RESULTS.

PROPERTY HIGHLIGHTS:

- Fully leased to long term tenant
- 5,505 sf service commercial building
- Asking price: \$1,200,000
- 4.34% blended cap rate

For more information

PLEASE CONTACT:

Kyle Dodman
d 604.424.9837
c 604.309.9446
kyled@FLRE.ca

Todd Bohn
Personal Real Estate Corporation
d 604.676.4138
c 778.808.8633
todd@FLRE.ca

FLRE.ca

FOR SALE

FULLY LEASED SERVICE COMMERCIAL BUILDING

31897 & 31899
Mercantile Way
Abbotsford, BC

OPPORTUNITY

Frontline Real Estate Services is pleased to present the opportunity to acquire a commercial investment property in Abbotsford's Clearbrook area. The subject property is fully leased to a single, long term tenant: Pinnacle West Inc. Located adjacent to Highway 1 it boasts exceptional exposure and convenient access via the Clearbrook Road interchange.

PROPERTY FEATURES

- Fully leased to single tenant
- Lease expiry: January 31, 2022
- 5,505 sf building (rentable) on 11,350 sf lot
- Zoned C4 (Service Commercial)
- Bare land strata
- Highway 1 exposure and access
- 10 minutes to Abbotsford International Airport
- 12 minutes to US border (Sumas)

CAP RATE ANALYSIS

Date	NOI	Cap Rate
Feb 2017	\$49,200	4.1%
Feb 2018	\$49,200	4.1%
Feb 2019	\$49,200	4.1%
Feb 2020	\$56,400	4.7%
Feb 2021	\$56,400	4.7%

PROPERTY DOCUMENTATION

Additional information regarding the property is available upon request, please contact the listing agents.

PROPERTY TAXES

\$11,443.20 (2015)

ASKING PRICE

\$1,200,000

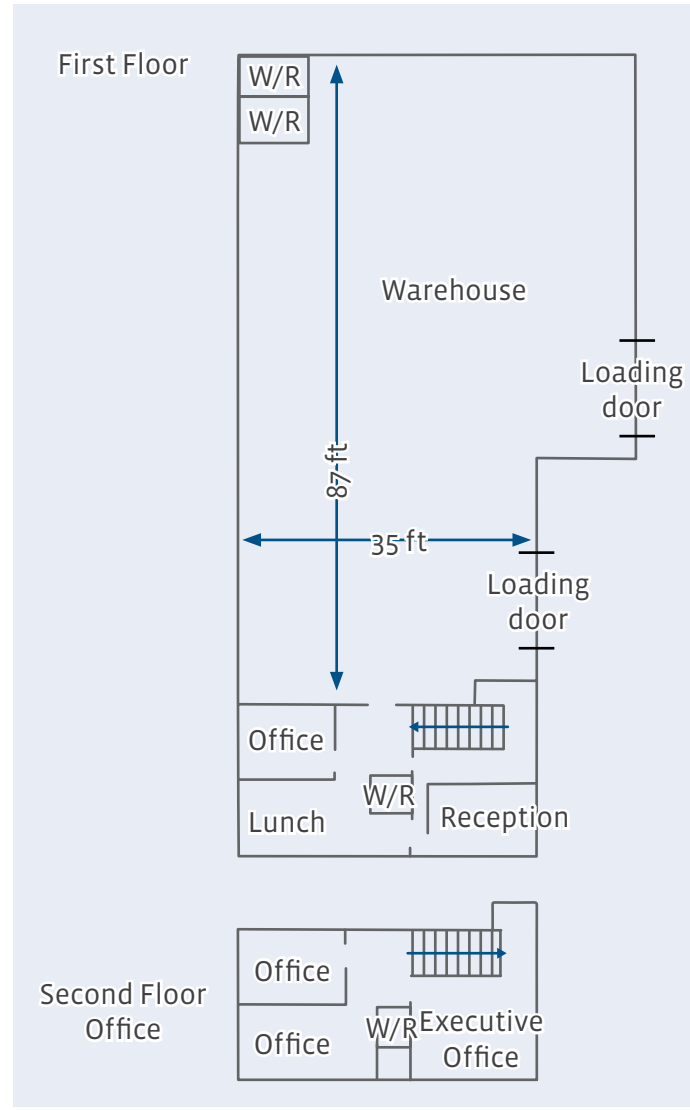

E.&O.E: This document/email has been prepared by Frontline Real Estate Services Ltd. for advertising and general information only. The information contained herein was obtained from sources which we deem reliable and, while thought to be correct, is not guaranteed by Frontline Real Estate Services Ltd. Any interested party should undertake their own inquiries as to the accuracy of the information. Frontline Real Estate Services Ltd. excludes unequivocally all inferred or implied terms, conditions and warranties arising out of this document and excludes all liability for loss and damages arising there from.

LOCAL FOCUS. POWERFUL RESULTS.