

# FOR LEASE

5,360 SF IN MULTI TENANT COMPLEX

3, 4, 5 - 30686 Matsqui Place  
Abbotsford, BC



**FRONTLINE**  
REAL ESTATE SERVICES

LOCAL FOCUS. POWERFUL RESULTS.

## PROPERTY HIGHLIGHTS:

- 5,360 sf warehouse
- Highway 1 exposure
- 3 front grade loading doors
- Asking lease rate: \$8.25 psf net

*For more information*

PLEASE CONTACT:

Kyle Dodman  
d 604.424.9837  
c 604.309.9446  
kyled@FLRE.ca

Todd Bohn  
Personal Real Estate Corporation  
d 604.676.4138  
c 778.808.8633  
todd@FLRE.ca

**FLRE.ca**

# FOR LEASE

5,360 SF IN MULTI TENANT COMPLEX

3, 4, 5 - 30686 Matsqui Place  
Abbotsford, BC

## OPPORTUNITY

A rare opportunity to lease three contiguous units in a multi tenant industrial complex with an office and shop. The subject property's location provides quick access to Highway 1, Fraser Highway and the Abbotsford International Airport. The Sumas border crossing is conveniently located approximately 16 minutes southeast.

## PROPERTY FEATURES

- 3 grade loading doors
- Three phase and single phase power
- 16.5 foot clear to trusses
- Gated and secure complex
- New lighting and paint
- Highway 1 exposure

## AVAILABILITY

DESCRIPTION	SIZE
Office	500 sf
Shop (16.5' ceiling)	4,860 sf
<b>TOTAL</b>	<b>5,360 sf</b>

## ZONING

Zoned I2 (General Industrial) which permits a wide range of industrial uses.

## LEASE RATE

\$8.25/sf net

## ADDITIONAL RENT

\$2.75/sf

## TOTAL MONTHLY RENT

\$4,913 plus GST and utilities

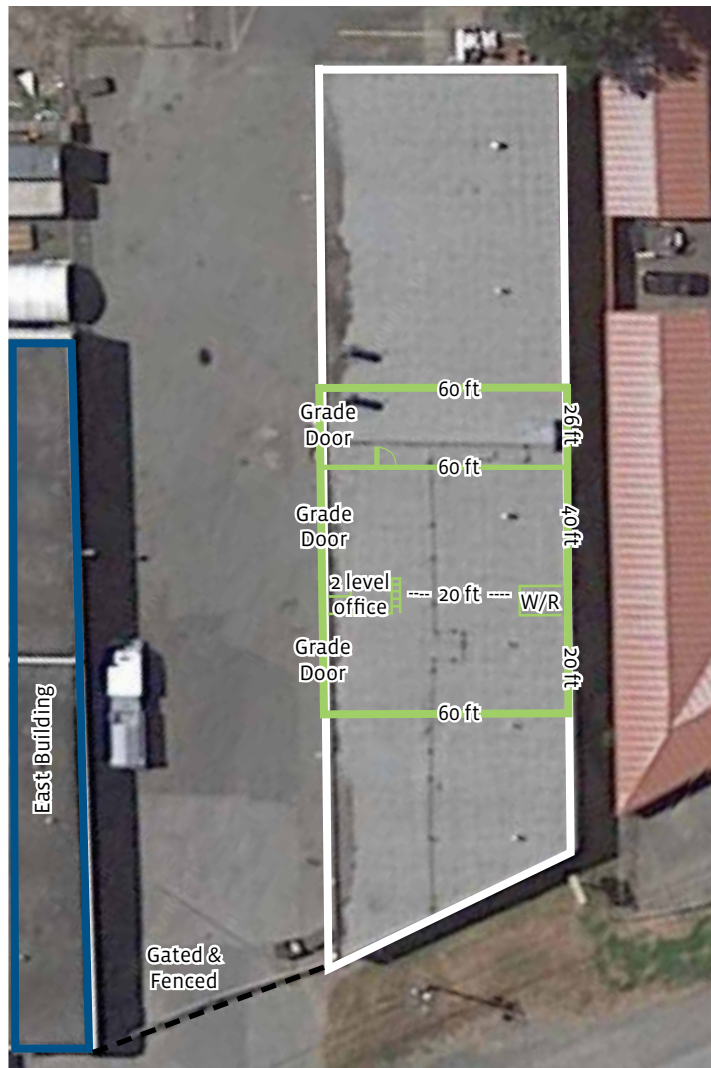

E.&O.E: This document/email has been prepared by Frontline Real Estate Services Ltd. for advertising and general information only. The information contained herein was obtained from sources which we deem reliable and, while thought to be correct, is not guaranteed by Frontline Real Estate Services Ltd. Any interested party should undertake their own inquiries as to the accuracy of the information. Frontline Real Estate Services Ltd. excludes unequivocally all inferred or implied terms, conditions and warranties arising out of this document and excludes all liability for loss and damages arising there from.