

soleil

New Dental Office For Lease in White Rock



Built by



Sales & marketing by



For more information

604.687.8300

contact@FLRE.ca

soleil

1,834 sf Dental Office

103 - 1588 Johnston Road, White Rock

This ground floor dental office is located in Soleil, a new mixed-use development positioned on a high exposure corner in White Rock Town Centre, the main gateway to the community.

Property Highlights

- 1,834 sf unit
- Shell space allowing for custom build out
- Signage opportunities
- Frontage on North Bluff Road (16 Avenue)
- 178 residential units providing a built in customer base
- Ample surface and underground parking stalls plus 4 loading stalls
- Join a medical clinic, daycare, and RBC
- CR-1 zoning accommodates a wide range of commercial uses
- Estimated possession Q1 2023

Basic Rent

\$40 psf

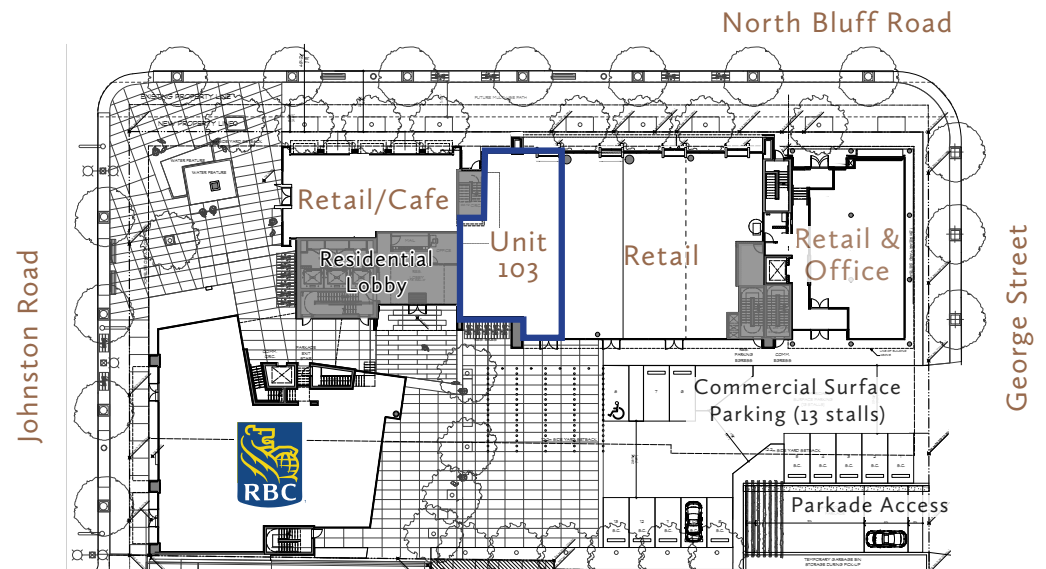
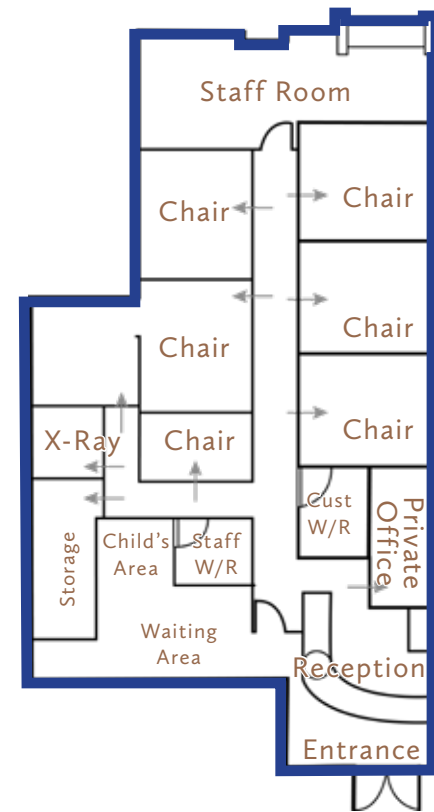

Proposed floor plan for illustrative purposes only.

soleil

Location

White Rock Town Centre

Located on the southeast corner of North Bluff Road (16 Avenue) and Johnston Road (152 Street) in uptown White Rock, Soleil offers a high exposure location in a desirable, accessible and walkable neighbourhood. The surrounding area boasts a variety of service businesses, shops, and dining options including those at Semiahmoo Shopping Centre, which is kitty corner from the subject property and home to 75+ shops including Save-On-Foods, Shoppers Drug Mart, and a BC Liquor Store.

White Rock's updated Official Community Plan has a strong focus on the continued rejuvenation of the White Rock Town Centre. The City is working to create a boutique retail environment by implementing signage bylaws, creating public spaces, and encouraging a variety of businesses that will serve both local residents and tourists alike.

Soleil is a mixed-use development that, along with the new retail and office units, will bring 178 new homes to White Rock Town Centre. It is one of many mixed-use developments planned for the immediate area. These include another mixed-use tower with 129 homes located directly east of Soleil and the recently completed 21 storey PARC Retirement Living community directly to the south.



soleil

For More Information

Please Contact

 **FRONTLINE**
REAL ESTATE SERVICES

604.687.8300

contact@FLRE.ca

